



PM-10



PM-20



PM-30

## Primo Mixer Manual

FOR OPERATOR - DO NOT DISCARD



5659 Royalmount Ave.  
Montreal, QC H4P2P9 CANADA  
Telephone: (514) 737-9701  
Toll Free Telephone: 1-888-275-4538  
Fax: (514) 342-3854

3560 NW 56th St.  
Fort Lauderdale, FL 33309 USA  
Telephone: (786) 600-4687  
Toll Free Telephone: 1-844-218-8477  
Fax: (786) 661-4100  
Email: [service@mvpgroupcorp.com](mailto:service@mvpgroupcorp.com)

For service call 1-888-275-4538



## IMPORTANT NOTES AND INSTRUCTIONS

### TAKING POSSESSION OF YOUR MIXER

Examine your new mixer for any shipping damage. Report any such damage to the carrier for compensation. Every mixer has left the factory fully tested and inspected. Shipping damage which may occur during transit is the responsibility of purchaser.

Move the crated unit as close as possible to its permanent location. When ready to uncrate, carefully remove all crating. Carefully place the mixer to a permanent position. Unit must be installed on a solid, level surface.

### INSTALLATION NOTES:

Please ensure that during shipping none of the components have loosened.

Select a location for the mixer keeping these points in mind:

- Floor or counter must be level.
- Easy access for maintenance and service.
- Clearance for operating controls, installing and removing agitators, bowl, or attachments.
- Sufficient space for adding ingredients during mixing periods.

### TO AVOID SERIOUS PERSONAL INJURY:

ALWAYS install equipment in work area with adequate light and space.

ONLY operate the mixer on a solid, LEVEL, non-skid surface.

NEVER bypass, alter, or modify this equipment in any way from its original condition. Doing so may create hazards and will void warranty.

DO NOT attempt to lift or move the mixer alone, it takes two persons to move it.



### PM-10 & PM-20

The outlet must be 110 Volts and 15 Amps (NEMA 5-15). It should be on a dedicated circuit, and the electrical installation should be grounded. The circuit breaker protecting this line should be adequately sized to protect the wires. The line on which the unit is connected should not operate anything else. The use of an extension cord is prohibited. Never cut the ground pin of the plug.



### PM-30

The outlet must be 110 Volts and 20 Amps (NEMA 5-20). It should be on a dedicated circuit, and the electrical installation should be grounded. The circuit breaker protecting this line should be adequately sized to protect the wires.



### TO AVOID SERIOUS PERSONAL INJURY:

DO NOT remove the bowl guard.

DO NOT operate the mixer before reading the instruction manual first.

ALWAYS disconnect or unplug electrical power before cleaning, servicing, or adjusting any parts or attachments.

ALWAYS keep hands, hair, and clothing away from moving parts.





## PM-10



Emergency Stop Button

Start Button

Speed Lever

Bowl Lift

Safety Cage

## PM-20



### ATTACHING THE BOWL TO THE MIXER

NOTE: Install the bowl BEFORE attaching the agitators.

1. Lower the bowl by pulling the bowl lift lever forward and down to its resting position
2. Lift the bowl by the bowl handles and slowly position the locking pin (located on the rear of the bowl) into the hole in the middle rear of the cradle. Lower the bowl onto the pins located on either side of the bowl cradle.
3. Once the bowl is positioned on the cradle, secure the bowl by pulling each bowl clamp forward until the bowl is locked tight.

### ATTACHING THE AGITATOR TO THE MIXER (i.e., Beater, Hook, Whip)

NOTE: It is easier to install the agitator prior to adding the ingredients into the bowl.

1. Rotate the safety cage to the left so it rests in the open position (tilt up for PM-30). Excessive force used to open and close the safety cage may damage the spring lock and safety cage micro-switch, and will void the warranty.
2. Slide the agitator slowly upwards onto the agitator shaft fitting the shaft pin through the slot in the agitator.
3. Rotate the agitator clockwise to secure it onto the agitator shaft.





## PM-30

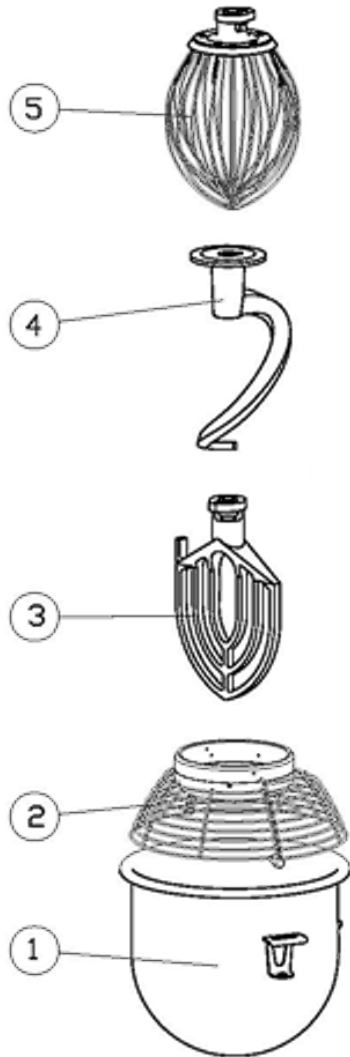

- 1 Bowl
- 2 Safety Cage
- 3 Flat Beater
- 4 Dough Hook
- 5 Wire whip



### MIXING INGREDIENTS

Follow the capacity chart in this manual.

Overloading or not following this chart will damage the mixer and void the warranty. Agitators should always rotate in a clockwise direction around the bowl. If the agitator moves Counter-clockwise, contact MVP Group immediately to remedy incorrect wiring.

**IMPORTANT:** Make sure the speed control lever is on the first (1) speed.

1. Add the appropriate mixing ingredients into the bowl.
2. Lift completely up on the bowl lift lever until the bowl locks into position.
3. Rotate (PM-10, PM-20) or pull down (PM-30) the bowl guard so it is into the closed position.

A clicking sound will be heard.

**NOTE:** The mixer will not start if the bowl guard is open or the bowl is in the lowered position.

4. Select the appropriate speed setting by rotating the speed control lever.



**Always STOP the mixer BEFORE** changing speeds! Failure to do so may damage the gears or other parts and WILL void the warranty!

Gear Speed Product Type/Ingredient

- 1 (low) Heavy: mixing pizza, bread, pasta and donut dough, waffle/cake batter, mashing potatoes
- 2 (medium) Medium: 2nd stage of mixing for donut dough, etc.
- 3 (high) Light: whipping cream, egg whites, meringue.

IMPORTANT: When mixing product always use the recommended attachment and follow the speed setting according to the capacity chart of this manual.

Make sure the emergency switch is not engaged by either pushing (PM-10, PM-20) or turning and pulling it (PM-30).

Press the green start button located on the middle of the control panel.

## General guideline for mixing

Refer to capacity chart for recommended quantities

Model	Volume of bowl	Max. Flour	Max. Dough
PM-10	10 QT.	4.5 lbs(2 Kg)	7 lbs(3.15 Kg) *
PM-20	20 QT.	9 lbs (4Kg)	14 lbs (6.4 Kg)*
PM-30	30 QT.	13.2 lbs (6Kg)	21 lbs (9.5 Kg)*

\* 60% water 'A/R' ;Absorption Ratio "AR" - weight of water divided by weight of flour.

## Capacity chart\* (Do Not Exceed the recommended quantities)

PRODUCT	ATTACHMENT	SPEED(S)	PM-10	PM-20	PM-30
Bread or Roll Dough (heavy 55% AR)	Dough Hook	1	6 lbs.	12 lbs.	16 lbs.
Bread or Roll Dough (light/Med 60% AR)	Dough Hook	1	7 lbs.	14 lbs.	18 lbs.
Cup Cake	Flat Beater	1,2	8 lbs.	16 lbs.	22 lbs
Egg & Sugar for Sponge Cake	Flat Beater	1,2,3	6 lbs.	12 lbs.	16 lbs.
Egg White	Wire Whip	1,2,3	1.5 pts	2 pts	3 pts
Layer Cake	Flat Beater	1,2	8 lbs.	16 lbs.	22 lbs.
Mashed Potatoes	Flat Beater	1,2	8 lbs.	12 lbs.	20 lbs.
Mayonnaise (qts Oil)	Flat Beater	1,2	4.5 qts	10 qts	12 qts



## Capacity chart (cont.)

PRODUCT	ATTACHMENT	SPEED(S)	PM-10	PM-20	PM-30
Medium Pizza Dough (50% AR)	Dough Hook	1	NR**	NR**	12 lbs.
Meringue (qts Water)	Wire Whip	1,2,3	½ pts	¾ pts	2 pts
Pie Dough	Flat Beater	1,2	5 lbs.	10 lbs.	16 lbs.
Pound Cake	Flat Beater	1,2	6 lbs.	12 lbs.	18 lbs.
Raised Donut Dough (65% AR)	Dough Hook	1	NR**	6 lbs.	10 lbs.
Sheet Cake Batter	Flat Beater	1,2	5 lbs.	10 lbs.	14 lbs.
Sugar Cookie	Flat Beater	1,2	8 lbs.	12 lbs.	16 lbs.
Thick Pizza Dough (60% AR)	Dough Hook	1	NR**	10 lbs.	14 lbs.
Thin Pizza Dough (40% AR 5 minutes maximum mix time)	Dough Hook	1	NR**	NR**	10 lbs.
Waffle/Pancake Batter	Flat Beater	1,2	5 qts	8 qts	12 qts
Whipped Cream	Wire Whip	1,2,3	2 qts	4 qts	6 qts
Whole Wheat Bread Dough (70% AR)	Dough Hook	1	6 lbs.	10 lbs.	16 lbs.

\* The capacities shown are maximum capacities and presented as a guideline only.

\*\*Not recommended – will void warranty

Dough capacities are based on 70-degree F water temperature and a 12% flour moisture.

Reduce batch if water under 70 degrees F

If high Gluten Flour used, reduce batch size by 10%

% AR = Water weight (lbs.) divided by flour weight (lbs.)

1 gallon water weighs 8.33 lbs.

## Cleaning instructions

**Always** clean the mixer after every use.

**Never** use pressured water to clean the mixer.

Agitator attachment must be removed and cleaned daily.

**Always** disconnect the mixer when cleaning.

Use soap and water with a plastic brush and rag.



The lifting mechanism should be kept cleaned daily and lubricated regularly with mineral oil only as required. **NEVER** use vegetable oil.



Figure 1



## MEAT GRINDER AND VEGETABLE ATTACHMENTS (OPTIONAL)\*

### HOW TO USE

1. Before first use, wash all parts of Meat Grinder or Vegetable Shredder.
2. Make sure the On/Off Switch is in the Off position.
3. Secure attachment properly in the mixer hub (figure 1).
4. Assemble the meat grinder / shredder attachment.
5. Place a bowl or plate beneath the grinder tube to catch food.
6. Switch appliance to On position. The Meat Grinder must ALWAYS be ON before adding food.
7. Place food on the hopper and use pusher to feed food through opening.
8. NEVER mix and cut at the same time.

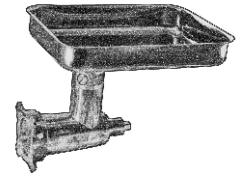

### HELPFUL HINTS

- Grinding pieces of stale bread may help remove food residue left in the Meat Grinder after use.
- Cut food into strips or cubes slightly smaller than the opening on the die-cast hopper.
- Make sure food is free of bone, tough tendon, nutshells, etc., before grinding.
- Freshly ground meat should be refrigerated and cooked within 24 hours.
- During extended grinding, fats from meats can build up inside the grinder tube, slowing down grinding and straining the motor. If this happens, you should stop the MIXER, wash parts in hot water, and reassemble. When possible, alternate meat with bread. This helps keep the feed screw clean.

### CLEANING AND MAINTENANCE

- Always unplug MIXER when not in use, before inserting or removing parts, and before cleaning.
- Wash all parts except MIXER in hot soapy water, using care when handling the sharp blades.
- Rinse these parts with clear hot water, then dry.
- Wipe MIXER with a damp cloth. Do not use harsh or abrasive cleaners.

\*: Sold separately



Fig 1



**Primo Mixer Limited Warranty**

MVP GROUP (“Primo”) warrants to the original purchaser of new mixer that said mixer, when installed in accordance with our instructions within North America and subjected to normal use, is free from defects in material or workmanship for a period of 2 years on parts (excludes wear/expendable parts). The labor warranty is 1 year on labor from original date of installation, or 18 months from actual shipment date, whichever date occurs first.

This warranty is in lieu of all other warranties, whether express or implied. MVP Group expressly disclaims any implied warranty of merchantability or express or implied warranty of fitness for a particular purpose. Primo’s obligation and liability under this warranty is expressly limited to repairing and replacing parts which proves to be defective in material or workmanship within the applicable warranty period.

MVP Group hereby states that: warranty travel time shall be limited to, and without exception, a round-trip total of two (2) hours OR mileage up to a maximum of sixty (60) miles round-trip. Any charges exceeding those stated herein must have prior authorization by the factory. All repairs pursuant to this Warranty will be performed by an Authorized Designated MVP Group Service Location during normal working hours.

In no event shall MVP Group be liable for incidental or consequential damages to buyer or any third party, including, without limitation, loss of property, personal injury, loss of business or profits or other economic losses, or statutory or exemplary damages, whether in negligence, warranty, strict liability, or otherwise.

This warranty is given only to the first purchaser from a retail dealer. No warranty is given to subsequent transferees. MVP Group assumes no liability for parts and labor coverage for component failure, factory defect or any other damages for units installed in a non-commercial or residential application. This warranty does not cover product malfunction caused by: failure to maintain, neglect, abuse, damage due to water, fire, normal wear, improper set up and use. Refer to mixer capacity chart. Periodic maintenance is not covered. This warranty is not in force until such time as a properly completed and signed installation/warranty registration or an online registration form has been received by MVP Group within 30 days from the date of installation. Register online at [www. http://mvpgroupcorp.com](http://mvpgroupcorp.com).

The foregoing warranty provisions are a complete and exclusive statement between the buyer and seller. MVP Group neither assumes nor authorizes any persons to assume for it any other obligation or liability in connection with said equipment.

Example of items not covered under warranty, but not limited to just these items: 1. Acts of God, fire, water damage, vandalism, accident, theft. 2. Freight damage. 3. Improper installation or alteration of equipment. 4. Faults due to lack of regular maintenance. 5. Repairs made by anyone other than a MVP Group designated service agent. 6. Lubrication. 7. Expendable wear parts. (This includes the bowl, flat beater, wire whip, spiral dough hook.) 8. Cleaning of equipment. 9. Misuse or abuse. 10. Use of generic or after-market parts. 11. Usage beyond its capacity.

Models covered by this warranty: PM-10, PM-20, PM-30

If you have any questions, please contact our customer service department at the number below. Don’t forget to have your serial number.

# Contact

**SERIAL NUMBER:** \_\_\_\_\_

**MODEL:**  **PM-10**  **PM-20**  **PM-30** \_\_\_\_\_



5659 Royalmount Ave.  
Montreal, QC H4P2P9 CANADA  
Telephone: (514) 737-9701  
Toll Free Telephone: 1-888-275-4538  
Fax: (514) 342-3854

3560 NW 56th St.  
Fort Lauderdale, FL 33309 USA  
Telephone: (786) 600-4687  
Toll Free Telephone: 1-844-218-8477  
Fax: (786) 661-4100  
Email: [service@mvpgroupcorp.com](mailto:service@mvpgroupcorp.com)